

# FOR LEASE

250 W 96th St. Indianapolis, IN



Healthpeak® | DOC  
LISTED  
NYSE



## PROPERTY DETAILS:

- Building Size: 188,115 SF
- For Lease:
  - 1st Floor: 28,627 RSF
  - 2nd Floor: 39,861 RSF
  - 3rd Floor: 39,904 RSF
- Parking garage with direct access to building
- Conference and training center on site
- Fitness center available to tenants
- Located at the I-465 and Meridian Street interchange
- Highly visible location with signage opportunities



**Parkwood One West**  
250 W 96th St.  
Indianapolis, IN 46260



## CONTACT

Charles Yeo, CCIM, CPM  
Senior Vice President, Brokerage  
317-288-9006  
cyeo@cciin.com

Cornerstone Companies, Inc.  
8902 N Meridian Street, Suite 205  
Indianapolis, IN 46260

# FLOOR PLANS

**1st Floor:**  
28,627 RSF

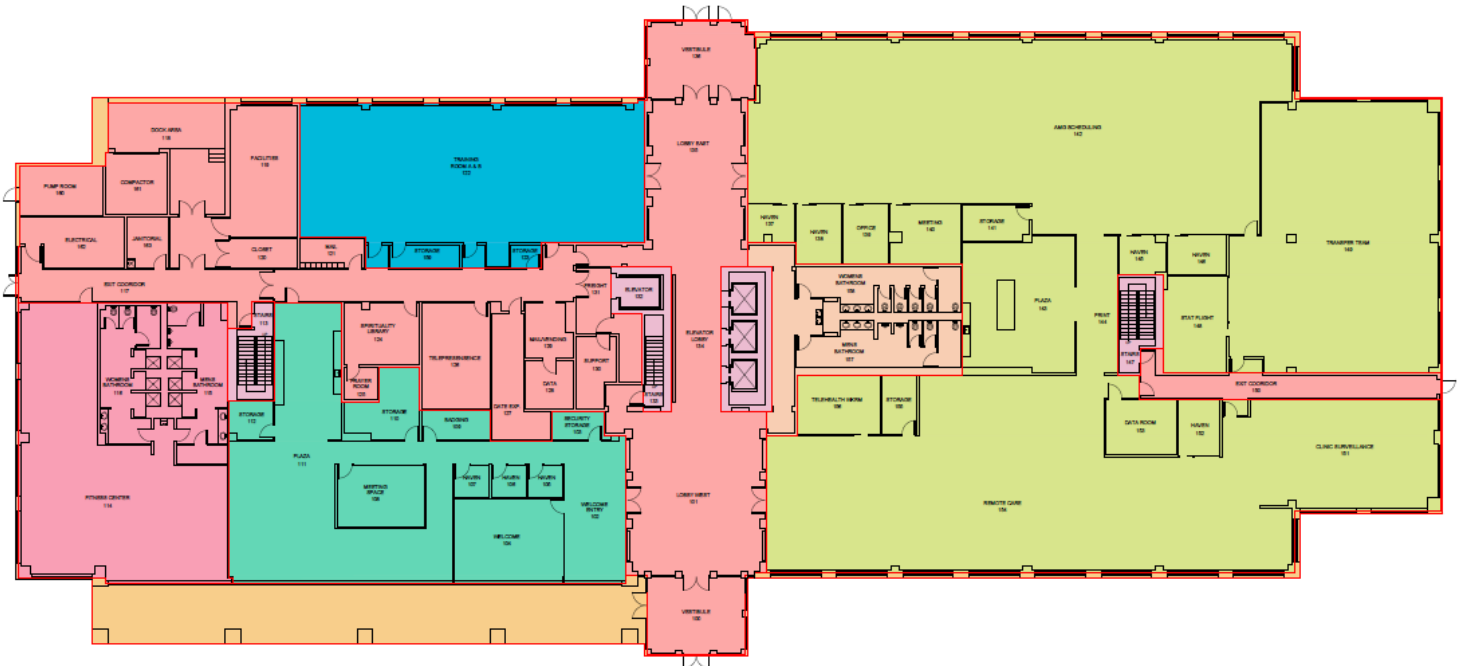

**2nd Floor:**  
39,861 RSF



# FLOOR PLANS

3rd Floor:  
39,904 RSF

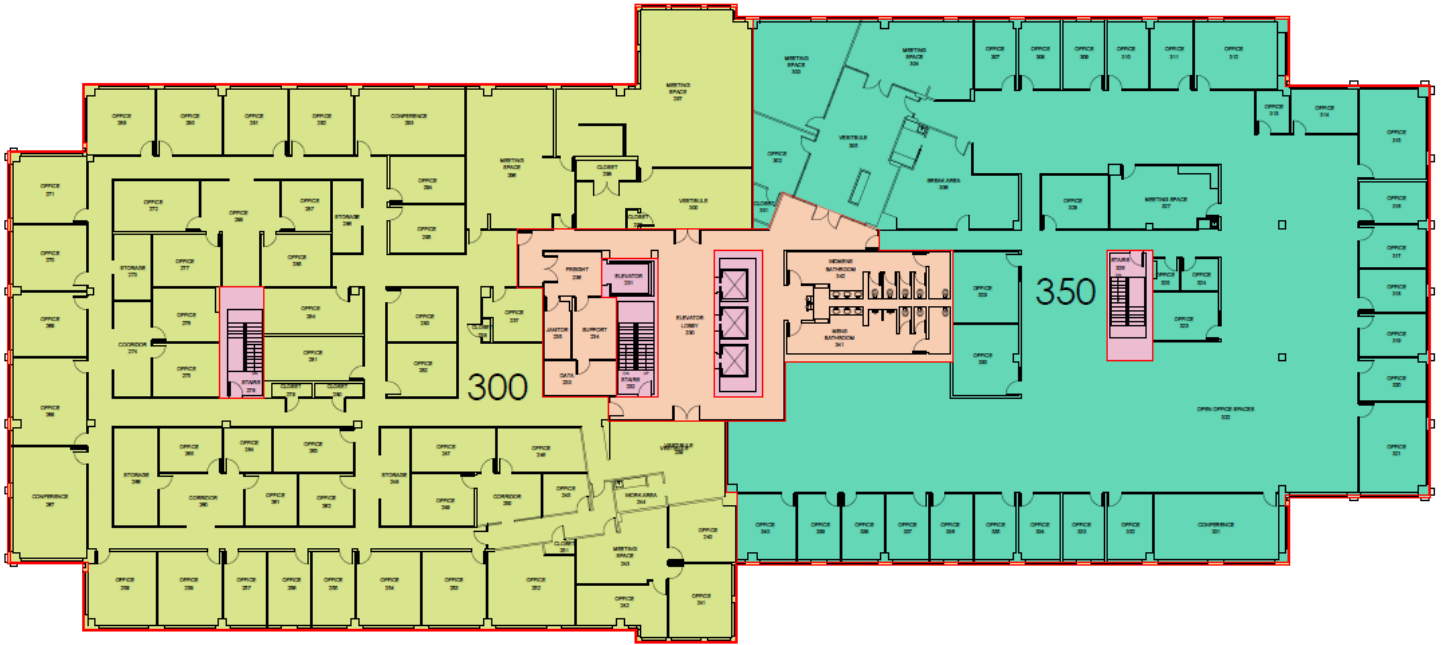

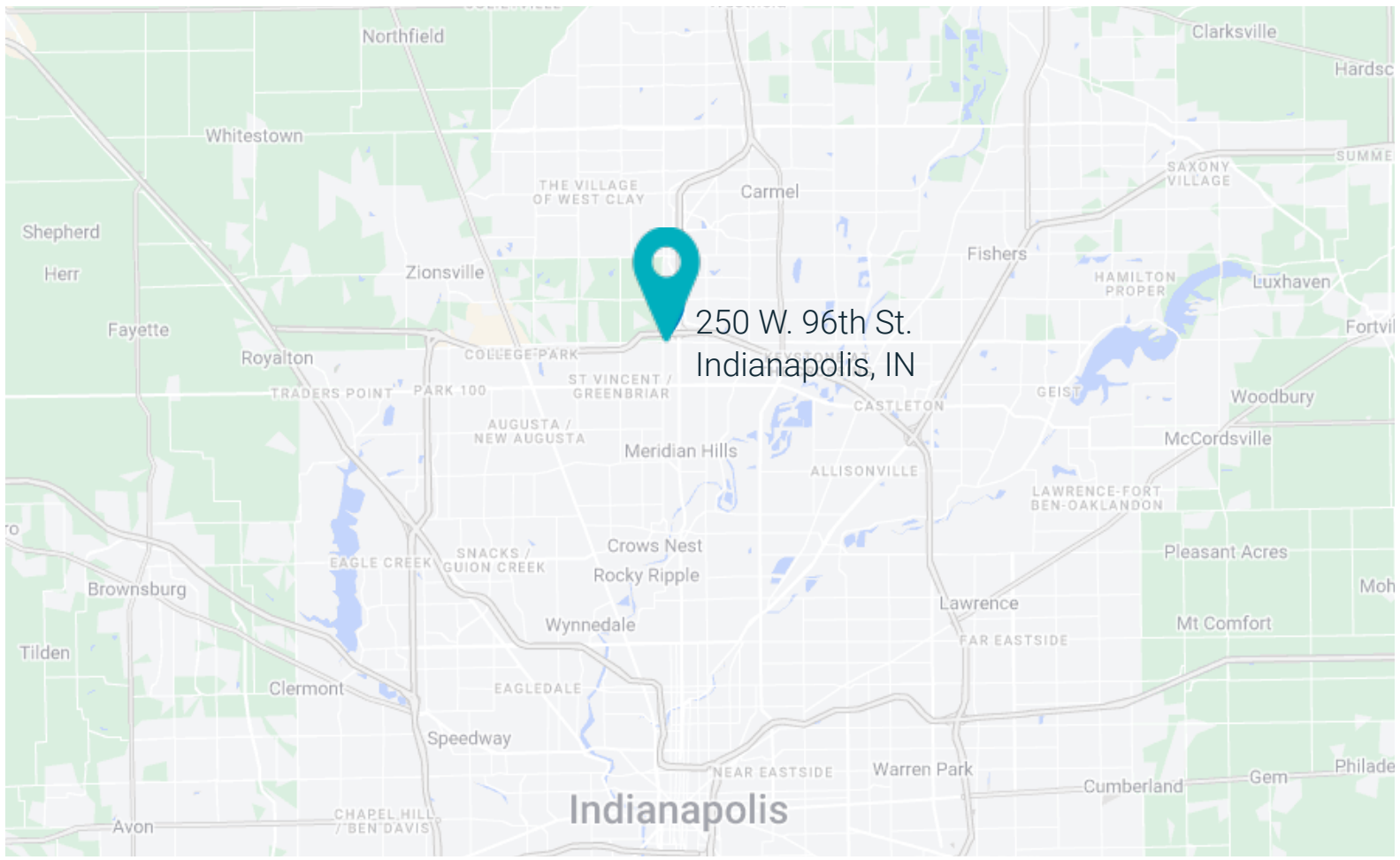

# DEMOGRAPHICS (5-mile radius)

 **181,008**  
Population

 **38.7**  
Median Age

 **77,824**  
Households

 **\$82,092**  
Median Household Income

## CONTACT

Charles Yeo, CCIM, CPM  
Senior Vice President, Brokerage  
317-288-9006  
cyeo@cciin.com

Cornerstone Companies, Inc.  
8902 N Meridian Street, Suite 205  
Indianapolis, IN 46260