

FOR LEASE

1668 S US Highway 421, Westville, IN



PROPERTY HIGHLIGHTS

- Building Size: 30,268 RSF
- Move-in ready cancer center with imaging center and bio-tech/lab space
- Across from Purdue University Northwest Westville Campus
- Located less than 15 minutes from Francis Beacon Hosital and Northwest Health - Porter Hospital
- Modern lobby with atrium and tenant lounge
- Abundant surface parking and separate tenant parking - 2.44 per 1,000 RSF parking ratio
- Building and monument signage opportunities
- Flexible terms and generous tenant improvement allowance



LaPorte Cancer Center
1668 S US Highway 421
Westville, IN 46391



CONTACT

Ross Goyer
EVP, Brokerage
317-288-9011
rgoyer@cciin.com

Cornerstone Companies, Inc.
8902 N Meridian Street, Suite 205
Indianapolis, IN 46260

FLOOR PLAN

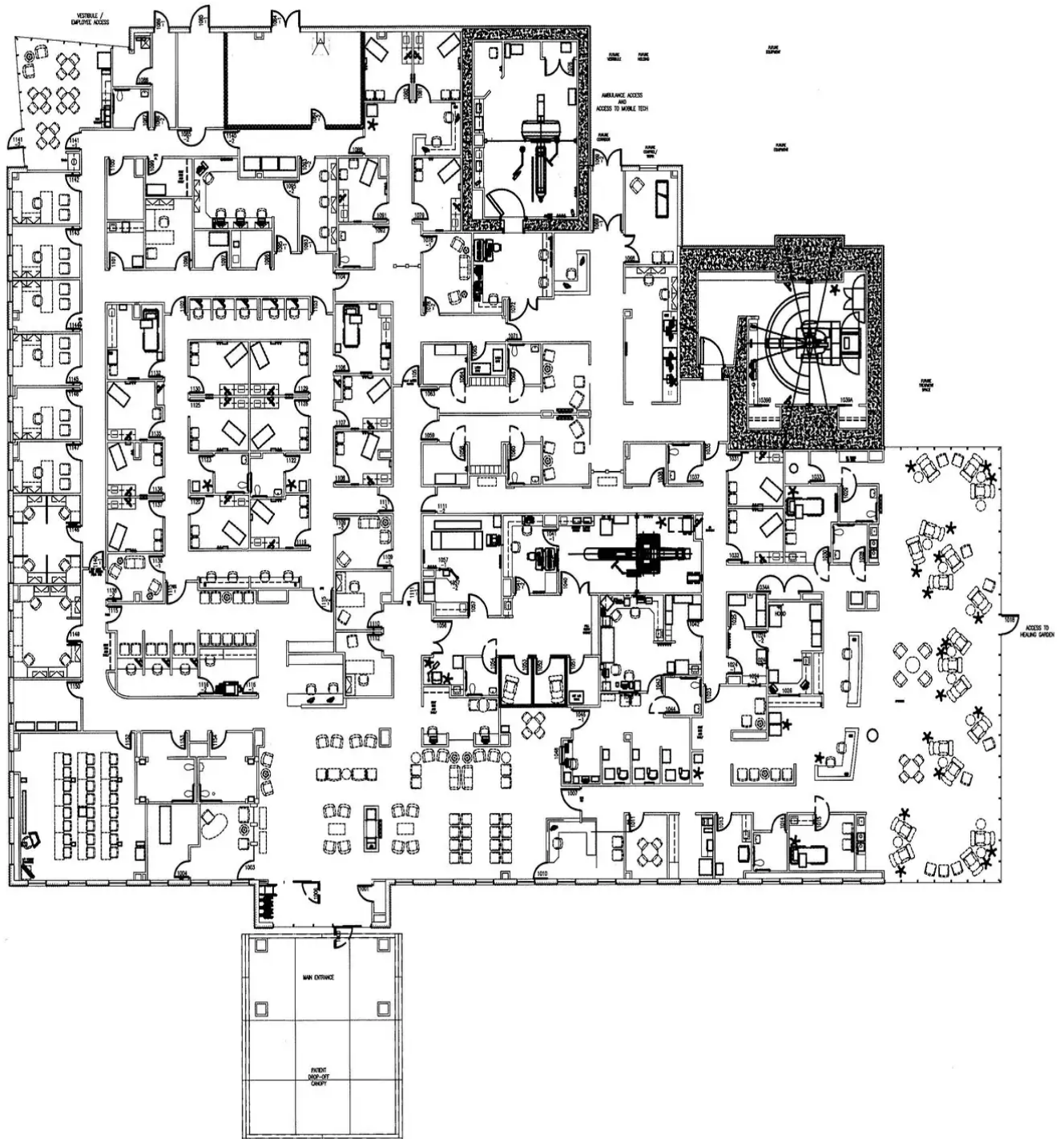

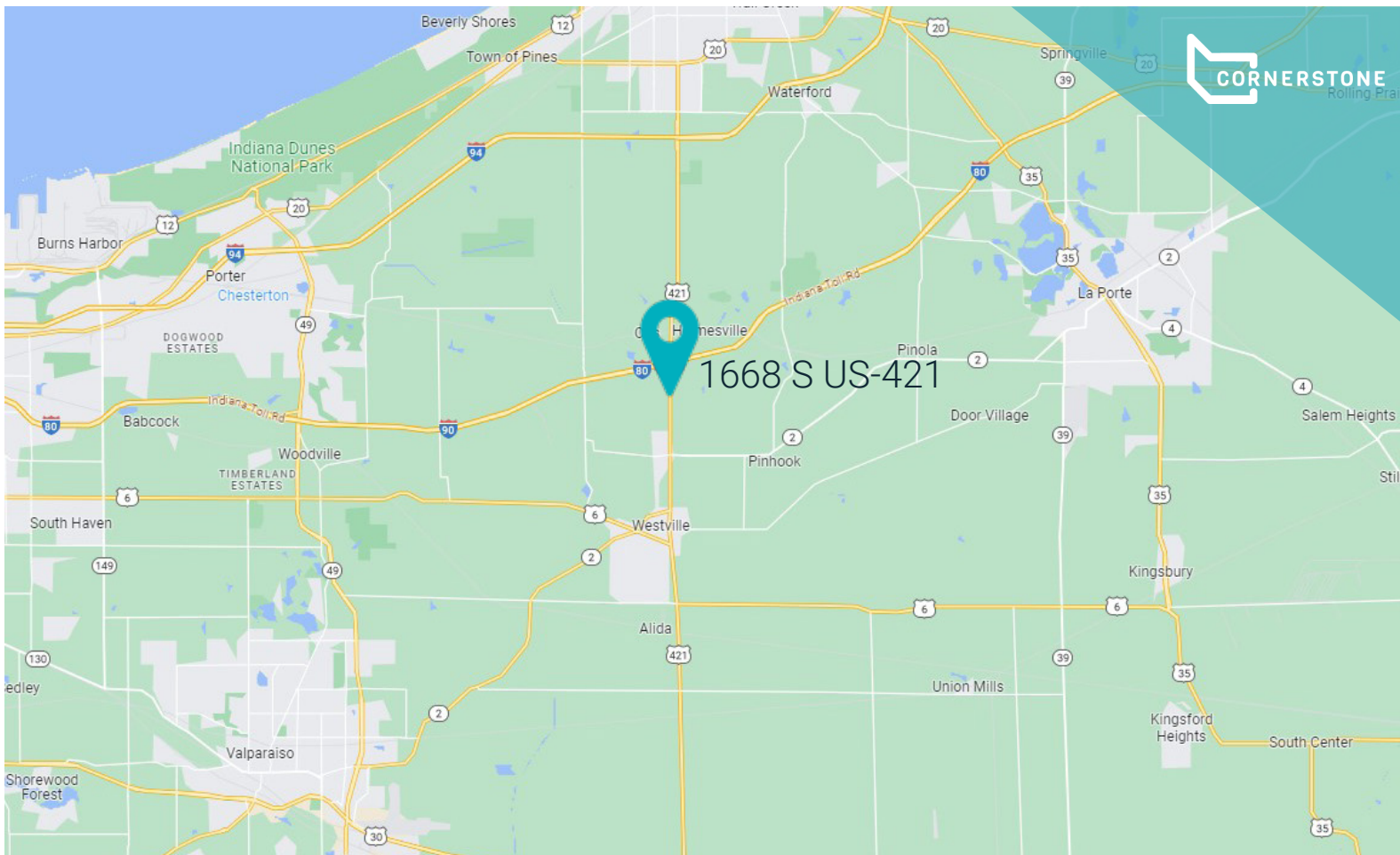

DEMOGRAPHICS (5-mile radius)

 14,668
Population

 \$98,676
Median
Household
Income

 81%
Population
Insured

 CONTACT

Ross Goyer
EVP, Brokerage
317-288-9011
rgoyer@cciin.com