

FOR LEASE

METHODIST MEDICAL PLAZA EAST

9650-9670 E Washington Street Indianapolis, IN



PROPERTY HIGHLIGHTS

- 62,386 SF medical office building with surgery center, radiology, and lab
- 2,164 SF medical office space for lease
- Ample parking
- Covered patient drop-off
- Highly visible building with monument signage opportunities
- Easily accessible from I-465
- Abundance of area amenities including retail, restaurants, and lodging



METHODIST MEDICAL PLAZA EAST
9650-9670 E Washington Street
Indianapolis, IN



CONTACT

Jennifer McAllister
Brokerage Associate
(317) 288-9022
jmcallister@cciin.com

Cornerstone Companies, Inc.
8902 N Meridian Street, Suite 205
Indianapolis, IN, 46260

FLOOR PLAN

Suite 205

2,164 SF

Former Optometry Office

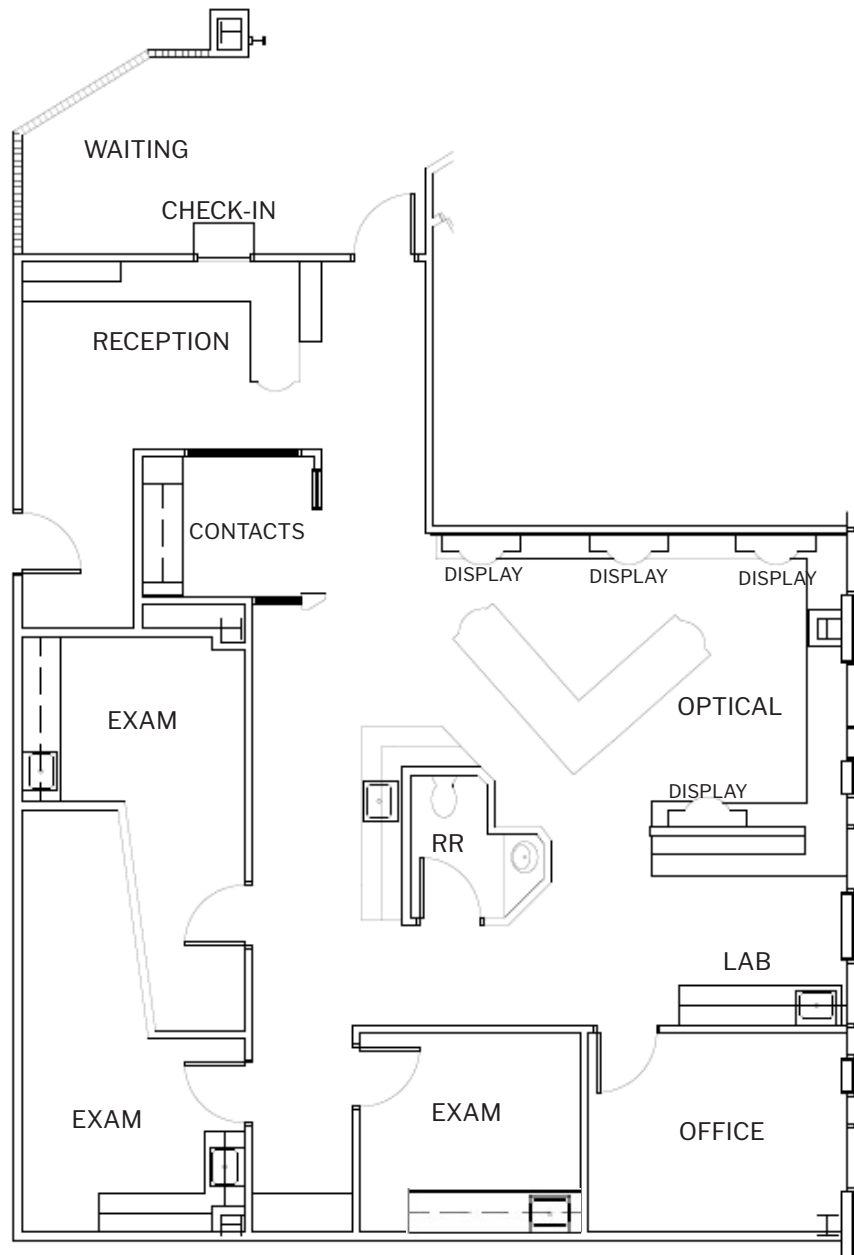

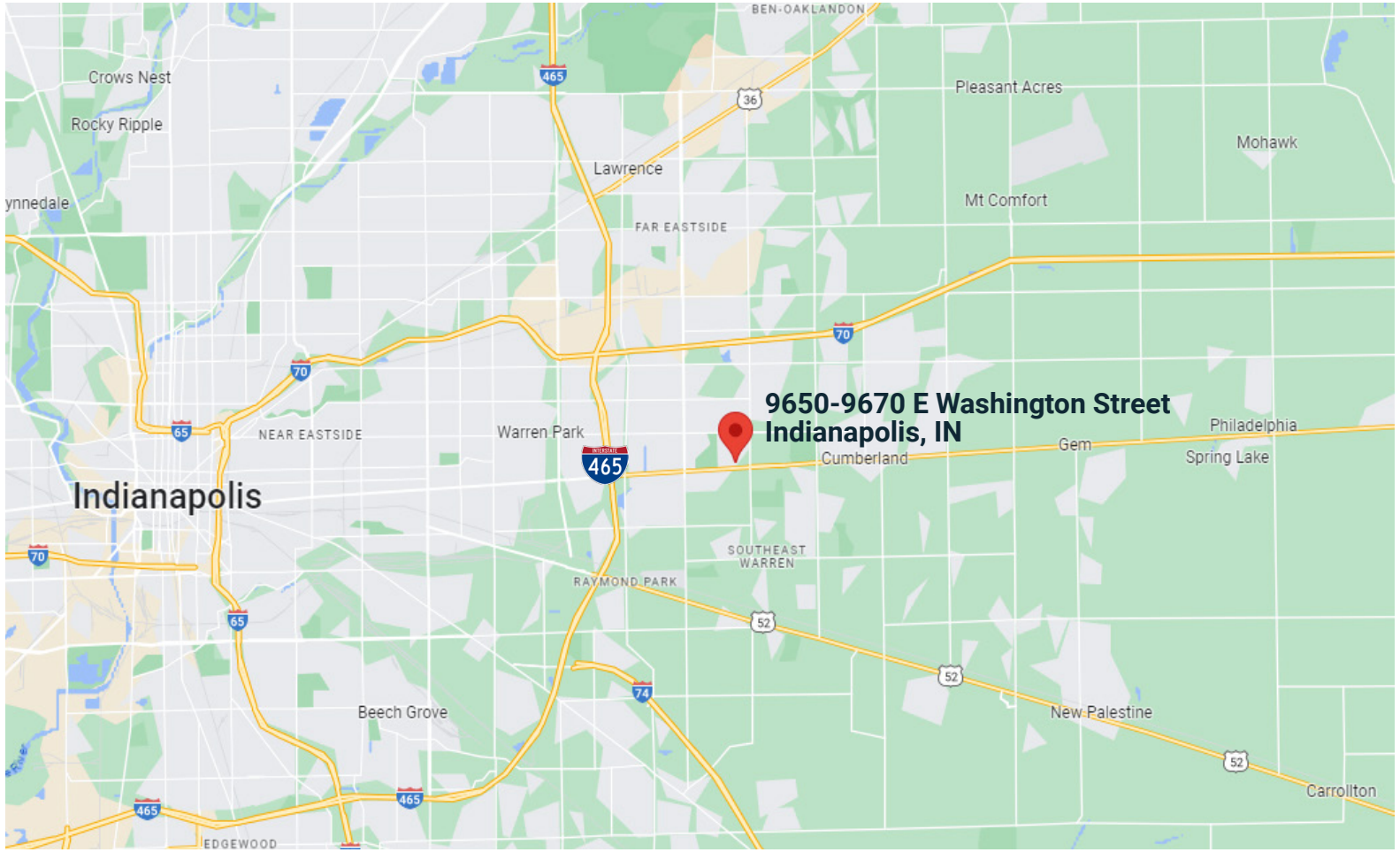

**9650-9670 E Washington Street
Indianapolis, IN**

DEMOGRAPHICS 5-MILE RADIUS

 **158,814**
Population

 **36.4**
Median Age

 **61,433**
Households

 **\$28,746**
Per Capita Income

 **\$55,717**
Median Household Income

CONTACT

Jennifer McAllister
Brokerage Associate
(317) 288-9022
jmcallister@cciin.com



© 2022 Cornerstone Companies, Inc. All rights reserved. Although the information contained herein has been obtained from sources deemed reliable, Owner, Cornerstone Companies, Inc., and/or their representatives, brokers or agents make no representation or warranty as to its accuracy or completeness. Any reliance on this information is solely at your own risk.