



# FOR LEASE

## PROPERTY HIGHLIGHTS:

- 4,899 RSF For Lease
- Class A medical office center anchored by DaVita Dialysis
- Surrounded by several medical practices and major health system clinics
- One mile from Franciscan Health Indianapolis
- High visibility along Emerson Avenue with 24,353 average daily traffic
- Prominent building signage available
- Immediate access to I-65

**EMERSON PARKE**  
972 EMERSON PARKWAY  
GREENWOOD, IN 46143

## CONTACTS:

---

**Charles Yeo, CCIM, CPM**  
Vice President  
317-288-9006  
cyeo@cciin.com

**Bill McClamroch**  
Brokerage Associate  
317-919-2992  
bmclamroch@cciin.com

**CORNERSTONE COMPANIES**  
8902 N Meridian St., Suite 205  
Indianapolis, IN 46260



For more, visit: [CornerstoneCompaniesInc.com](http://CornerstoneCompaniesInc.com)

# FLOOR PLAN

SUITE A:  
4,899 RSF

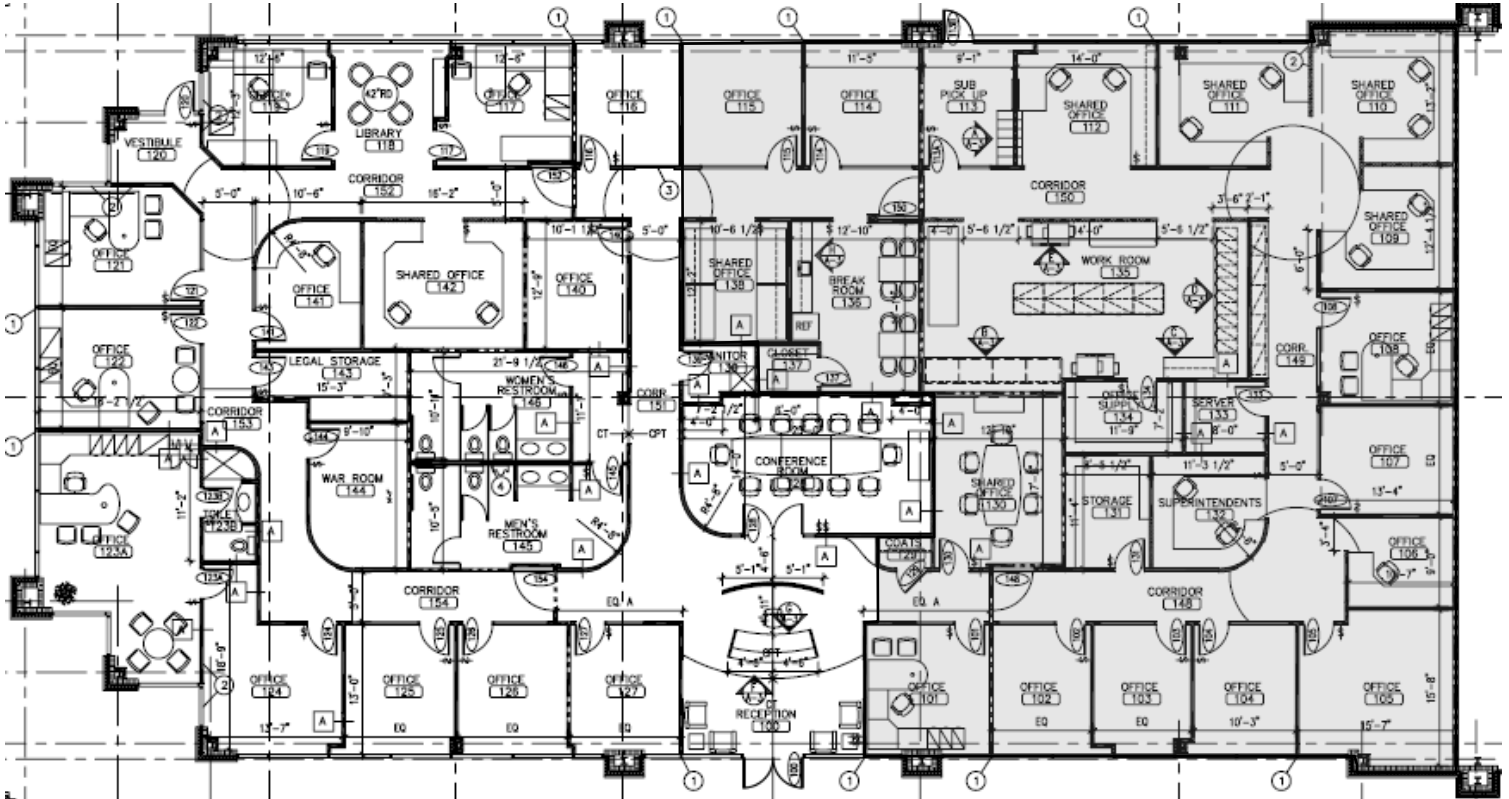

For more, visit: [CornerstoneCompaniesInc.com](http://CornerstoneCompaniesInc.com)

# LOCATION

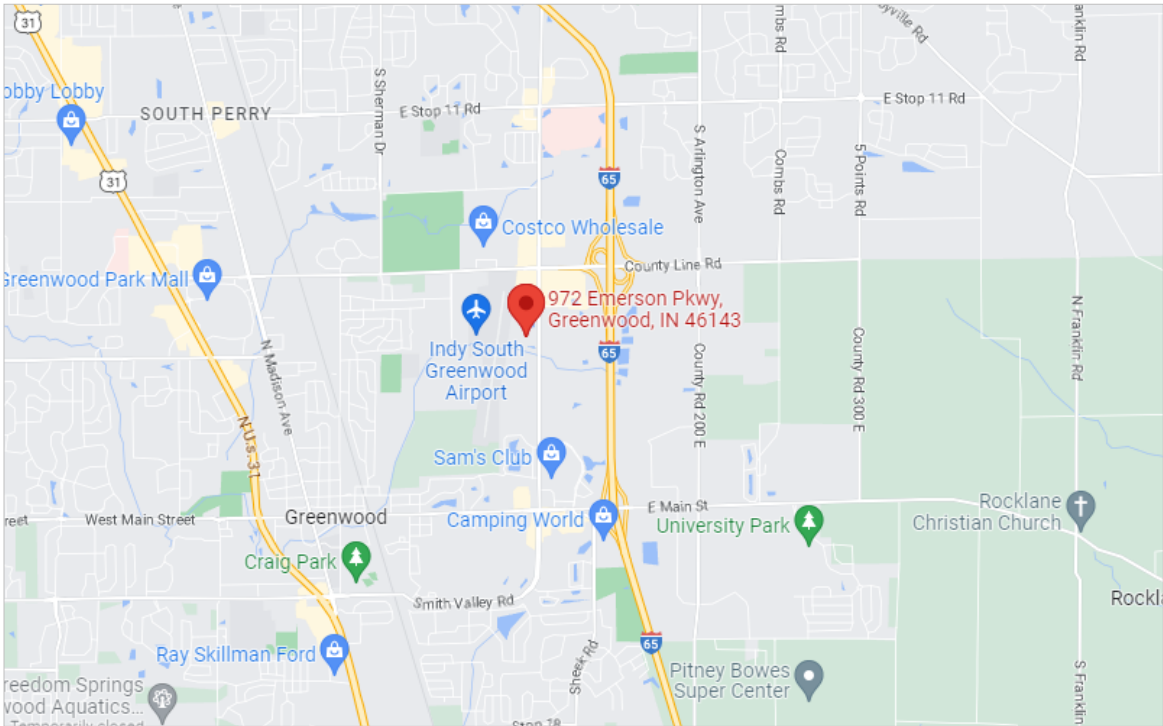

# DEMOGRAPHICS

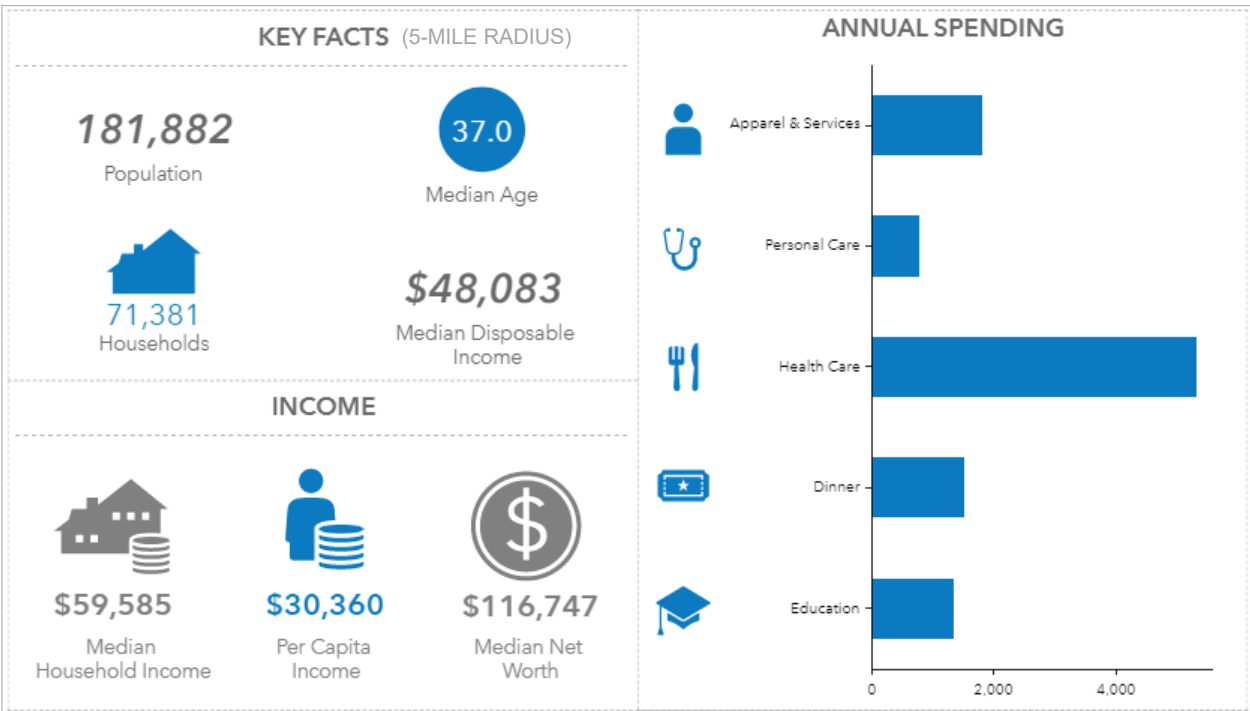

For more, visit: [CornerstoneCompaniesInc.com](http://CornerstoneCompaniesInc.com)